



# THE STEWARD

Protecting and Preserving the Ohio River Corridor

[www.westernwildlifecorridor.org](http://www.westernwildlifecorridor.org)

Spring 2015



## PRESIDENT'S JOURNAL

### How do You Protect a Corridor?

By Tim Sisson

The short answer is – one property at a time. The long answer is a little more complicated.

First you have to have a vision. For WWC it is simple - our vision, our basic existence, is based on the dream of protecting the beautiful Ohio River valley from the Mill Creek near downtown Cincinnati to the Indiana state line. The next step is where it becomes complicated. You want to acquire properties or Conservation Easements at key sites within your corridor. By getting to know our corridor and by promoting Western Wildlife Corridor to the communities and organizations nearby, we were able to acquire some really key properties.

Finally, you seek to build a region of protected land at these key sites. This is an important step. The tendency is to grab land wherever it is available. If you succumb to that temptation, you will wind up with fragmented properties that are not as beneficial for protecting wildlife. It is much better to build larger regions.

Western Wildlife Corridor had the good fortune this past winter to be able to protect additional properties in three such areas. In our last issue of the newsletter, I described our new Kirby Preserve that is adjacent to the Turkey Haven Preserve and very near property we already own on South Road. In addition to this, we acquired a property in Saylor Park linking two of our preserves and a property in Riverside adjacent to property we own.

As the map shows, the Saylor Park property is adjacent to Whitetail Woods and Black Walnut Gorge. It protects a large swath of the hillside and offers the potential for a hiking trail extending from Whitetail all the way to Rapid Run Road. This will offer people the opportunity to enjoy the very nice mature forest in this area as well as the scenic gorge next to Rapid Run Road.

The additional properties in Riverside do not offer the possibility of a trail yet, but they do serve as one of those important nuclei for an extensive area of protected land in the future.

With these important acquisitions we move even closer to the dream of a protected corridor on the west side of Cincinnati. If you know of a property in our corridor we might be able to acquire to help complete our dream, please let us know. Many of the properties we have protected in the past have resulted from just such a referral. Who knows, you may set us on the path to our next important acquisition.

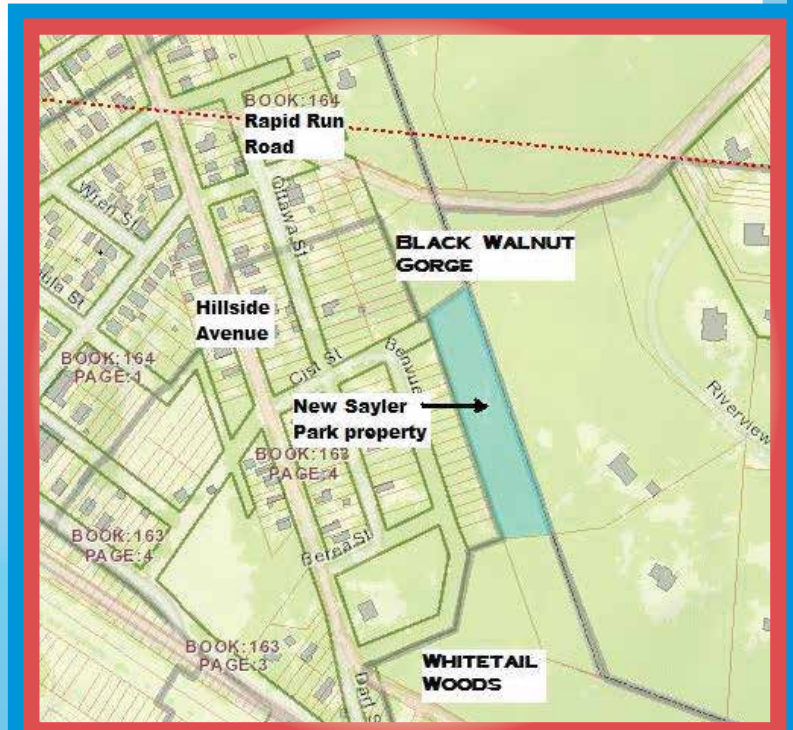

## Calling All Members - Our New Kirby Nature Center Needs You!

In the spirit of "Green Living", we have decided to recycle, reuse and rehab the house on the New Kirby Nature Preserve to be repurposed as the Kirby Nature Center. This represents an exciting new era for the WWC. The Nature Center will be our first ever home office and the hub of our activities and future events. We are in the process of evaluating and repairing this new facility



and are asking for volunteers from our talented membership to get the center shipshape.

If you have expertise in masonry, plumbing, carpentry, electrical wiring, landscaping, repair of aluminum siding, painting or any other special skills to help us in this important work, please email

Tim Sisson at

[wwc7@yahoo.com](mailto:wwc7@yahoo.com)

or call Tim at [513-922-2104](tel:513-922-2104).

Thanks!

## The Kirby Nature Preserve - Marking An Exciting New Era for The Western Wildlife Corridor

### Our Future Plans include:

#### \*A WWC Home Office for:

- Meetings and file storage
- Exhibits detailing our purpose, with information on other preserves
- Events such as the Flower-a-thon and Wildflower Festival
- Workshops providing training and education on nature topics
- Displays about the plants and animals found in the Corridor, and other environmental topics of interest

**\*An extensive trail system** connecting to other properties WWC owns and to regional trails in the future. The trails will allow visitors to enjoy hiking through several habitats and to view the beautiful Ohio River valley.

**\*Several biological zones:** mature forest, transitional second growth forest, prairie and riparian. These individual zones will be developed for education and recreation as well as to protect important natural resources.

**\*A Picnic Grove** with a large lawn, walnut trees, picnic tables, rain garden and public parking lot near the house.

30 Prime Acres in Addyston, Ohio



Future Home of  
Western Wildlife Corridor





**Sunday, April 12, 2 pm  
Wildflower Hike  
Delshire Preserve**



Delshire is glorious in the spring! Hillsides here are covered with many species of beautiful spring wildflowers. We will also be walking up a beautiful gorge through an old growth forest with immense Burr Oak trees. Our guide will be identifying these for us. For more on this event, which is also a "tune-up" for participants in our Flower-a-thon, contact Tim at 513.922.2104 or [wwc7@yahoo.com](mailto:wwc7@yahoo.com).

**Friday, April 17, 6 pm to 9 pm  
Ninth Annual Wildflower Festival  
Mount St. Joseph University**



Spring is just around the corner and to celebrate, Western Wildlife Corridor is holding our 9th Annual Wildflower Festival. The festival, which promotes education and awareness of area wildflowers, will be from 6-9 pm on Friday, April 17 in Mount St. Joseph University's Harrington Center.

Admission is FREE! There will be many activities for children and adults to enjoy. We will offer native plants and wildflowers for sale, raffles, a family-friendly class presented by the Greater Cincinnati Herpetological Society and displays by local nature organizations. There will also be art, pottery and jewelry for sale and many great educational activities for kids. Tasty food may be purchased in the college's food court. A wildflower poster (2x3 foot mounted) will be on sale as well as a laminated field guide/placemat.

For more information about the April 17th Wildflower Festival, contact Rebecca Sisson at 859.512.1983 or [wwc7@yahoo.com](mailto:wwc7@yahoo.com).

For the latest information about the festival or other Western Wildlife Corridor events, visit [www.westernwildlifecorridor.org](http://www.westernwildlifecorridor.org) or our Facebook page.

**Saturday, April 25, half day or all day  
Eleventh Annual Flower-a-thon**



It's a quest in search of beautiful wildflowers throughout the Western Wildlife Corridor. It's a day of hiking the beautiful forested hillsides of the Ohio River valley. These and much more are included in Western Wildlife Corridor's 2015 Flower-a-thon on April 25!

Enjoy the company of fellow wildflower enthusiasts around the fireplace with a bagel breakfast from 8 to 9 am at Embshoff Woods. Following breakfast, wildflower experts will lead groups through the forest at Embshoff and the Delshire Preserve to identify wildflowers and trees. At 1 pm there will be hikes on Bender Mountain trails to identify additional wildflowers and trees and to enjoy its fabulous forest and panoramic views of the Ohio River Valley. Additional hikes will be offered in

other nature preserves throughout the day. Hike leaders will include expert Denis Conover. This will be a great opportunity to spend time in nature with the family and to get unique photos!

At 5 pm we will gather at EarthConnection on the campus of Mount St. Joseph University for a lasagna dinner and to swap stories about our adventures. After dinner, Flower White will make a presentation entitled "Flowers of Southwest Ohio - Native Trees, Shrubs & Vines". This will include gorgeous close-up pictures of wildflowers (such as those on trees) that you usually don't get a chance to see. Displays will provide additional opportunities to learn the wildflowers of southwest Ohio. *See back cover of newsletter for pictures!*

A donation of \$15.00 per person is requested to cover the cost of the breakfast, hikes and dinner. Additional tax-deductable donations are also accepted. All proceeds from the event will benefit the Western Wildlife Corridor.

To register, please visit [www.westernwildlifecorridor.org](http://www.westernwildlifecorridor.org). For more information, contact Tim at 513.922.2104 or [wwc7@yahoo.com](mailto:wwc7@yahoo.com).

**Habitat Restoration:**

**Saturday, May 2, 9 am to noon  
Habitat restoration at Shady Lane**  
Leaders: Greg Lang at 513.404.5250  
and John Klein at 513.941.4877.

**Saturday, May 16, 9 am to noon  
House renovation or Habitat  
restoration at Kirby Nature Preserve**  
Leaders: Tim Sisson at 513.922.2104  
and Greg Lang at 513.404.5250.

**Saturday, May 30, 9 am to noon  
Habitat restoration at Buckeye Trace**  
Leaders: John Klein at 513.941.4877  
and Bruce Cortright at 513.451.5549.

**Saturday, June 13, 9 am to noon  
Habitat restoration at Whitetail Woods**  
Leaders: Tim Sisson at 513.922.2104  
and Greg Lang at 513.404.5250.

**Why habitat restoration?**

Many times the biggest threat to our preserves is invasion by alien plant species. Plants such as Amur (or bush) honeysuckle, euonymus and garlic mustard can produce such a dense cover of foliage that native plants cannot survive. We've been told that Amur honeysuckle even secretes a toxin that kills native plants! When we restore the habitat in one of our preserves, we remove these invasive alien plants so that native plants and animals can thrive.



**Habitat Restoration**

# Now is the Time

By Tim Sisson

**The Emerald Ash Borer**, an invasive insect from Asia, has invaded most of our region. It is predicted that it will eventually kill every ash tree here that hasn't been treated. They are definitely in our preserves - the one in this picture was found at our Bender Mountain Preserve this past summer. Western Wildlife Corridor has treated many ash trees in this and several of our other preserves - a total of 40 trees. We feel it is important to preserve some ash trees to show people in the future what an ash tree is and also to preserve a seed stock so that if (hopefully when) the ash borer is no longer a threat in the future, there will be a way for it to repopulate the region.

If you have ash trees that you would like to protect, now is the time to take action. The recommended timing for the injection method, the most effective means of treatment, is early May to mid-June. If you choose the soil drench method, the application can be made from now to late spring. For more information on the EAB and treatment methods, I recommend the excellent article "Insecticide Options for Protecting Ash Trees from Emerald Ash Borer" by Herms, McCullough, Smitley, Sadof, Williamson and Nixon at [www.emeraldashborer.info](http://www.emeraldashborer.info).



## Spring Beauties

By Sally Sisson Anderson  
WWC Artist in Residence

One spring, when I was out hiking close to Fiddlers Green Road, I came upon patches of beautiful pink wild flowers. Upon looking them up in my book, I discovered they were spring beauties of the Claytonia genus. The name Claytonia was given to the plant in honor of John Clayton, one of our earliest botanists. Spring beauty is one of 28 species in this genus in North America.

This small plant will often grow in large patches. It reproduces from underground tubers or seeds. The tubers are similar to very small potatoes. They are edible, and were once a favorite food of the Indians. Apparently, their flavor is similar to potato only better, but please don't dig them up. We prefer the wild flowers. Spring beauties became scarce in pioneer times because so many people were eating them for food.

The pink veins on this flower act as signs leading insects to the nectar. There are five petals to each delicate bloom. As for pollination, various bees visit spring beauties, including honey bees, bumblebees, and carpenter bees.

Many flies also visit the wild flower, and several butterflies including the skippers. The leaves are grass-like. Spring beauty is a small perennial that carpets the eastern woodlands from Canada through Ohio and Georgia, then west to Nebraska and Texas. Another species, Carolina spring beauty, has broader, shorter leaves. It blooms in the northeast and in the mountains to Alabama and Arkansas.

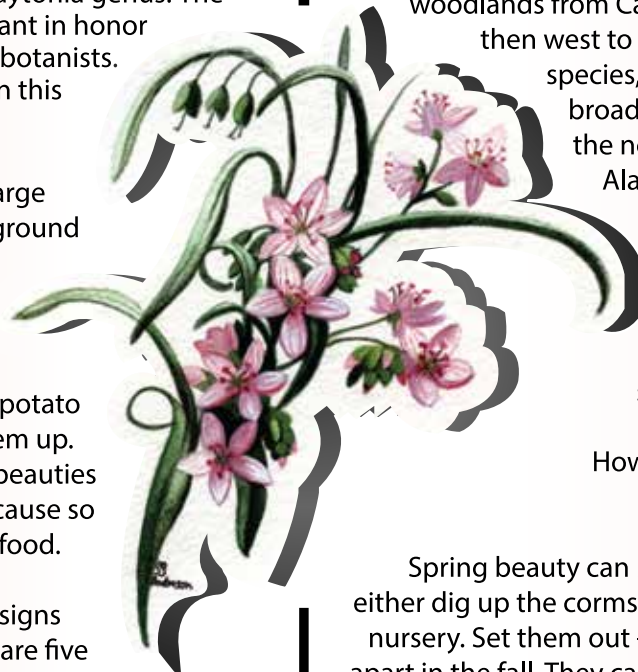

### HOW TO GROW

Spring beauty is suitable for growing in an area of partial shade. The plant needs soil rich in humus with sufficient moisture. However, it has been known to thrive in sunny lawns.

Spring beauty can be difficult to get started. You can either dig up the corms in the spring, or buy them from a nursery. Set them out - two inches deep and two inches apart in the fall. They can make a handsome addition to a wild flower garden or to a rock garden. To see a great display of spring beauties, look for them in April at the Bender Mountain preserve, or at the Delshire preserve.



# Registration for Western Wildlife Corridor 2015 Flower-a-thon

Tax deductible contribution for Flower-a-thon (\$15 per person) Total \_\_\_\_\_  
Name \_\_\_\_\_ Phone number \_\_\_\_\_  
Address \_\_\_\_\_ Apt. \_\_\_\_\_  
City, State, Zip \_\_\_\_\_ Email \_\_\_\_\_

Please return registration form and payment to:

Western Wildlife Corridor, Inc.  
PO Box 389077  
Cincinnati, OH 45238



Native Rose -  
Bender Road

Thank you for supporting the Western Wildlife Corridor's mission to preserve the scenic beauty and natural resources of the Ohio River Valley! WWC is an IRS certified 501(c)(3) non-profit organization.

## A Quick and Easy Way to Help WWC

Here's the easiest way to help Western Wildlife Corridor. Enroll in Kroger Community Rewards, then every time you shop at Kroger, WWC gets a percentage of what you spend. It adds up, and helps us to purchase and preserve wildlife habitat. Here's how to enroll:

1. Visit [Kroger.com/communityrewards](http://Kroger.com/communityrewards)
2. Sign in to your online account, or create an account
3. Find and select "Western Wildlife Corridor", then click "Save"

You need to re-enroll once a year, enrollment expires in April. Please take a few moments to enroll now. Every time you swipe your Kroger Plus Card, you could be helping to protect our beautiful nature preserves.

### Artist in Residence:

Sally Sisson Anderson

### Constant Contact Administrator:

Joyce Richter

### Facebook Administrator:

Mary Perkins

### Events:

Roselyn Schloss

Rebecca Sisson

### Fundraising:

Greg Lang

Tim Sisson

### Land Stewardship:

Tim Sisson

### Membership:

Walt McBeath

### Newsletter:

Katie Clark

Bob Nienaber

Mary Uhlenbrock

### Photographers:

Mary Perkins

Tim Sisson

### Website Coordinators:

Jeff Doering

Mary Perkins

## Please indicate how you would like to help!

### JOIN WESTERN WILDLIFE CORRIDOR 2015-2016

☐ New Membership

☐ Renewal

Enclosed is my tax deductible contribution at the following membership level:

\_\_\_\_ \$20 Individual      \_\_\_\_ \$30 Family      \_\_\_\_ \$75 Supporting

\_\_\_\_ \$50 Organization      \_\_\_\_ \$100 Patron      \_\_\_\_ \$500 Sponsoring

\_\_\_\_ Other      \_\_\_\_ /month Guardian

**\*NEW!! BECOME A MEMBER ONLINE! [www.westernwildlifecorridor.org](http://www.westernwildlifecorridor.org)**

### DONATE TO THE LAND ACQUISITION FUND

☐ Enclosed is my tax deductible donation for the land acquisition fund \$ \_\_\_\_\_

### VOLUNTEER YOUR SERVICES

May we contact you with volunteer opportunities? ☐ Yes

☐ Help with Habitat Restoration      ☐ Help with Outreach and other needs

### PLAN FOR THE FUTURE

☐ I would like to know more about including the WWC in my estate plans.

Name \_\_\_\_\_ Phone Number \_\_\_\_\_

Address \_\_\_\_\_ Apt. \_\_\_\_\_

City, State, Zip \_\_\_\_\_ Email \_\_\_\_\_

Please mail to:  
Western Wildlife Corridor, Inc.  
PO Box 389077  
Cincinnati, OH 45238

Thank you for supporting the Western Wildlife Corridor's mission to preserve the scenic beauty and natural resources of the Ohio River Valley!

Western Wildlife Corridor is a 501 (c) (3) tax exempt organization.



PO BOX 389077  
Cincinnati, OH 45238-9077

513.921.WILD (9453)  
www.westernwildlifecorridor.org  
Email: wwc7@yahoo.com

Non-Profit  
Organization  
US Postage  
PAID  
Cincinnati, OH  
Permit #571

### WWC Board of Trustees

**Tim Sisson, President**

**Bruce Cortright, Vice President**

**Robert Thomas, Treasurer**

**Mary Perkins, Secretary**

Ned Keller

John Klein

Greg Lang

Walt McBeath

Leesa Miller

Bob Nienaber

Joyce Richter SC

Roselyn Schloss

Rebecca Sisson

Jessee J. Smith



Printed on recycled paper.



**Eastern Wahoo - *Euonymus atropurpureus* -  
Celastraceae - 05-27-14 - Hamilton Co, OH**

Flower White



**Wild Geranium -  
Bender Mtn.**

Tim Sisson



**Shagbark Hickory flowering - *Carya ovata* -  
Juglandaceae 04-21-12 -  
Brown Co, OH Cropfield Fencerow**

Flower White



**Spring Beauty -  
Delshire Preserve**

Tim Sisson



**Black Walnut  
female & male flowers  
*Juglans nigra*  
Juglandaceae - 05-10-11  
Brown Co, OH**

Flower White



**Blue Cohosh**

Tim Sisson